

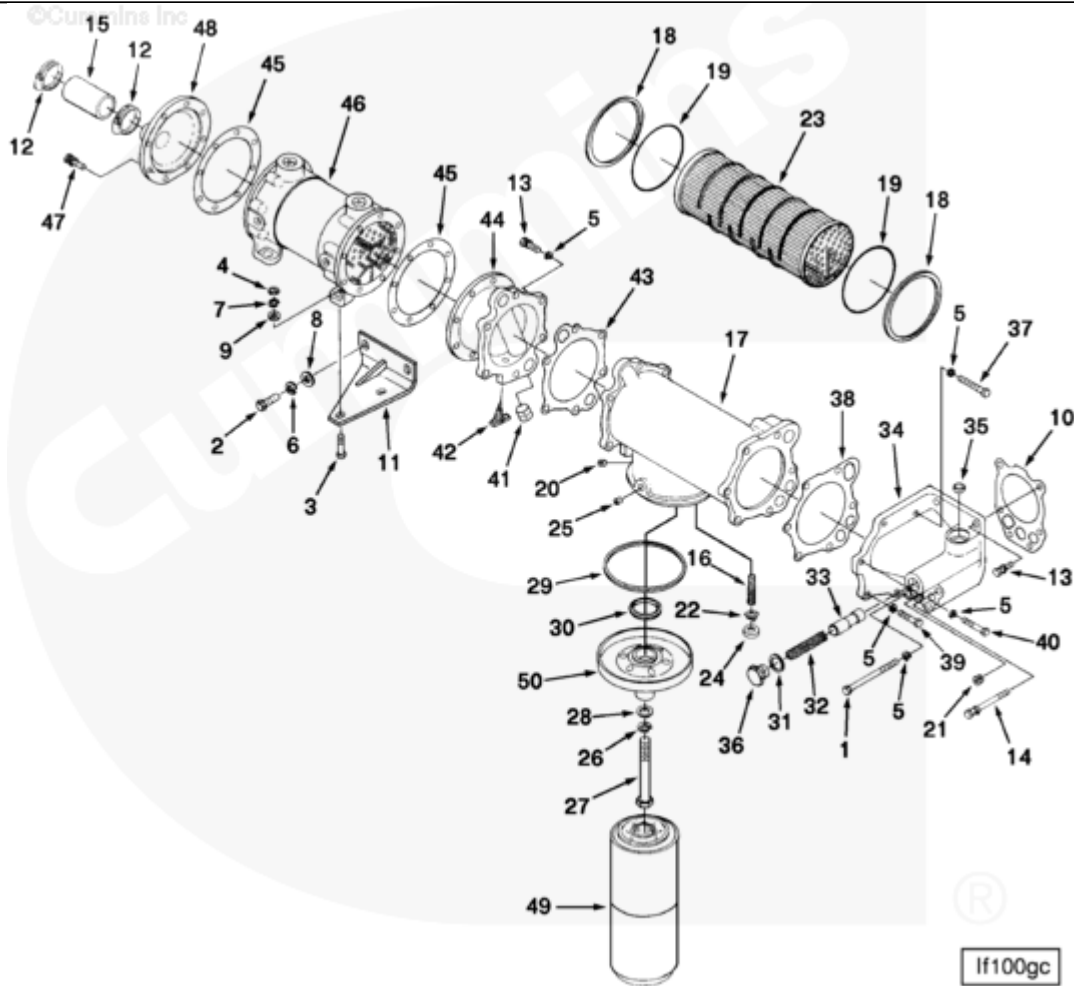

## Parts Catalog - Option Detail

Electronic Parts Catalog - Option Detail				
Option	Group	Graphic	Film Card	Date
LF1046	07.05	If100gc	F	15-FEB-95
<b>Engines</b>	NH/NT 855, NT495, NT743, NTA855 N106			



[SMALL](#) | [MEDIUM](#) | [LARGE](#)

Cart	Ref No	Part Number	Part Description	Required	Remarks
<a href="#">View My Cart</a>					
		<a href="#">LF1046</a>	Lubricating Oil Cooler		
					Lube Oil Cooler
					Lube oil filter-cooler for
					FFC engines. Includes marine

					gear oil cooler and spin-on
					type filter element.
<input type="checkbox"/>	1	S 106 C	Hexagon Head Cap Screw	2	3/8 - 16 X 4 3/4 in.
<input type="checkbox"/>	2	S 145	Hexagon Head Cap Screw	2	1/2 - 13 X 1 1/4 in.
<input type="checkbox"/>	3	S 155	Hexagon Head Cap Screw	2	7/16 - 14 X 1 1/2 in.
<input type="checkbox"/>	4	S 217	Heavy Hexagon Nut	2	7/16 - 14 UNC.
<input type="checkbox"/>	5	S 604	Lock Washer	5	3/8 in.
<input type="checkbox"/>	6	S 608	Lock Washer	2	1/2 in.
<input type="checkbox"/>	7	S 610	Lock Washer	2	7/16 in.
<input type="checkbox"/>	8	203310	Plain Washer	2	9/16 in.
<input type="checkbox"/>	9	3000082	Plain Washer	4	15/32 in.
<input type="checkbox"/>	10	3008017	Oil Cooler Support Gasket	1	
<input type="checkbox"/>	11	3010346	Oil Cooler Bracket	1	
<input type="checkbox"/>	12	3010518	Hose Clamp	2	1 1/2 - 2 in.
<input type="checkbox"/>	13	3010596	Captive Washer Cap Screw	11	3/8 - 16 x 1 1/4 in.
<input type="checkbox"/>	14	3010597	Captive Washer Cap Screw	2	3/8 - 16 X 3 3/4 in.
<input type="checkbox"/>	15	3031560	Plain Hose	1	
<input type="checkbox"/>		AR 9999	Lubricating Oil Cooler	1	
<input type="checkbox"/>	16	202128	Compression Spring	1	
<input type="checkbox"/>	17	210915	Oil Filter Cooler Housing	1	
<input type="checkbox"/>	18	3006745	Retaining Ring	2	
<input type="checkbox"/>	19	3007713	O-Ring Seal	2	
<input type="checkbox"/>	20	3008466	Pipe Plug	1	1/4 NPT.
<input type="checkbox"/>	21	3013786	Pipe Plug	2	3/8 NPT.
<input type="checkbox"/>	22	3018673	Valve Disc	1	
<input type="checkbox"/>	23	3021581	Cooler Core	1	
<input type="checkbox"/>	24	3023994	Retainer Plug	1	
<input type="checkbox"/>	25	3025458	Pipe Plug	1	1/8 NPT.
<input type="checkbox"/>	26	S 603	Lock Washer	1	5/8 in.

<input type="checkbox"/>	27	138045	Hexagon Head Cap Screw	1	5/8 - 18 X 5 in.
<input type="checkbox"/>	28	200861	Plain Washer	1	5/8 Inch.
<input type="checkbox"/>	29	3302630	Breather Gasket	1	
<input type="checkbox"/>	30	3308958	Rectangular Ring Seal	1	
<input type="checkbox"/>	31	67946	Plain Washer	1	1 1/32 in.
<input type="checkbox"/>	32	68274	Compression Spring	1	
<input type="checkbox"/>	33	127558	Pressure Regulator Plunger	1	
<input type="checkbox"/>	34	210967	Oil Cooler Support	1	
<input type="checkbox"/>	35	213394	Expansion Plug	1	
<input type="checkbox"/>	36	3060882	Threaded Plug	1	1 - 18 UNS
<input type="checkbox"/>	37	S 126	Hexagon Head Cap Screw	1	3/8 - 16 X 2 1/2 in.
<input type="checkbox"/>	38	3010030	Lubricating Oil Cooler Cover Gasket	1	
<input type="checkbox"/>	39	S 120	Hexagon Head Cap Screw	1	3/8 - 16 X 1 3/4 in.
<input type="checkbox"/>	40	S 137	Hexagon Head Cap Screw	1	3/8 - 16 x 2 in.
<input type="checkbox"/>	41	S 995	Pipe Plug	1	3/4 NPT.
<input type="checkbox"/>	42	176307	Draincock	1	
<input type="checkbox"/>	43	218245	Lubricating Oil Cooler Cover Gasket	1	
<input type="checkbox"/>	44	3010344	Oil Cooler Support	1	
<input type="checkbox"/>	45	67378	Water Transfer Connection Gasket	2	
<input type="checkbox"/>	46	210722	Cooler Core	1	
<input type="checkbox"/>	47	3010595	Captive Washer Cap Screw	16	3/8 - 16 X 1 in.
<input type="checkbox"/>	48	3013307	Gear Oil Cooler Cover	1	
<input type="checkbox"/>	49	3889310	Lubricating Oil Filter Element	1	
<input type="checkbox"/>	50	3300908	Lubricating Oil Filter Head	1	